

REC007545



Crawford County Recorder Denise Meeves
 FEE BOOK 2005-2191 8/17/2005 @ 11:12AM
 PLC PLAT CORNER CERBook: Page:05-2191 #: 1
 Total Fees: \$7.00

WILKE LAND SURVEYING 401 1800th Street Panama, Iowa 51562 (712)489-2898 CELL(712)579-0551

UNITED STATES PUBLIC LAND SURVEY CORNER CERTIFICATE

SECTION 15 TOWNSHIP 82N RANGE 38W COUNTY CRAWFORD

Certificate Prepared For: Survey of a Parcel "A" in the SW1/4, SE1/4,
of Section 15, T82N, R38W.

Monument Description and Remarks:

SE CORNER, SEC. 15, T82N, R38W
 Found concrete monument with brass disc,
 1.0' deep with rebar on the West side for
 metal detection, using ties obtained from the
 I.D.O.T District 3 office.

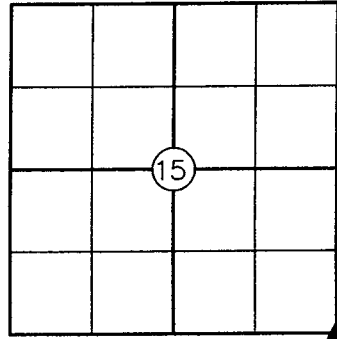

List of Corners to be Indexed			
Corner	Section	Twp.	Range
SE CORNER	15	82N	38W

SE CORNER, SECTION 15, T82N, R38W

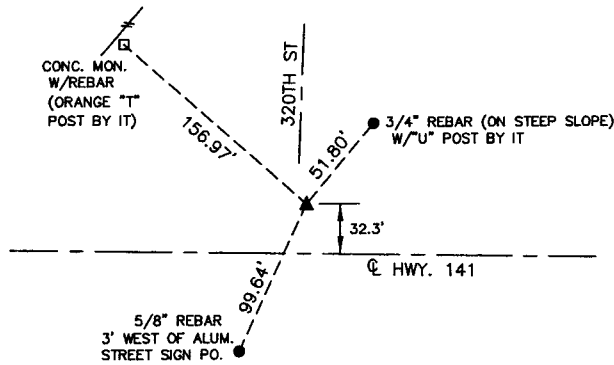

All Distances Hor.
W/Total Station

FOUND CONCRETE MONUMENT W/BRASS DISC, 1.0' DEEP IN COUNTY ROAD,
 W/REBAR ON WEST SIDE FOR METAL DETECTION.

	I hereby certify that this land surveying document was prepared and the related survey work was performed by me or under my direct personal supervision and that I am a duly licensed Land Surveyor under the laws of the State of Iowa.
	<p><i>Dean A. Wilke</i> 8/08/05 Dean A. Wilke P.L.S. Date</p> <p>License number 17048 My license renewal date is December 31, 2005 Pages or sheets covered by this seal: <u>This page only</u></p>