

Sara Meseck, RECORDER
 Crawford County, Iowa
 Instr. Number: 2024-1185
 Recorded: 7/11/2024 at 9:21:11.0 AM
 Pages 1
 County Recording Fee: \$7.00
 Iowa E-Filing Fee: \$3.13
 Combined Fee: \$10.13
 Revenue Tax:

PREPARED BY AND RETURN TO: MIKE SCHULTE, SCHULTE SURVEYING, INC., 2003 390TH STREET, WESTSIDE, IA 51467 (712) 790-3489

UNITED STATES PUBLIC LAND SURVEY CORNER CERTIFICATE OF
 LAND SURVEY MONUMENTS SITUATED IN SECTION 14, TOWNSHIP 84 NORTH, RANGE 38 WEST, OF THE FIFTH
 PRINCIPAL MERIDIAN, CRAWFORD COUNTY, IOWA. PREVIOUSLY RECORDED IN SEE BELOW IN COUNTY
(book, page, instrument number)
 RECORDER'S OFFICE.

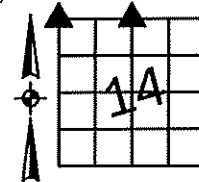

NW CORNER

FND 1" IRON PIN 10" DEEP

N=7272379.27 E=16632214.21 Z=1276.69

USED CERTIFICATE RECORDED IN INSTRUMENT #97-1948 AND A METAL LOCATOR TO FIND A 1" IRON PIN 10" DEEP. VERIFIED WITH 1 REMAINING TIE AND SURROUNDING FIELD EVIDENCE. THIS CERTIFICATE IS BEING FILED TO UPDATE THE REFERENCE TIES.

N1/4 CORNER

FND 1" IRON PIN 4" DEEP

N=7272370.00 E=16634844.35 Z=1325.43

USED CERTIFICATE RECORDED IN INSTRUMENT #2001-1670 AND A METAL LOCATOR TO FIND A 1" IRON PIN 4" DEEP AS DESCRIBED. VERIFIED WITH 3 REMAINING TIES. THIS CERTIFICATE IS BEING FILED TO UPDATE THE REFERENCE TIES.

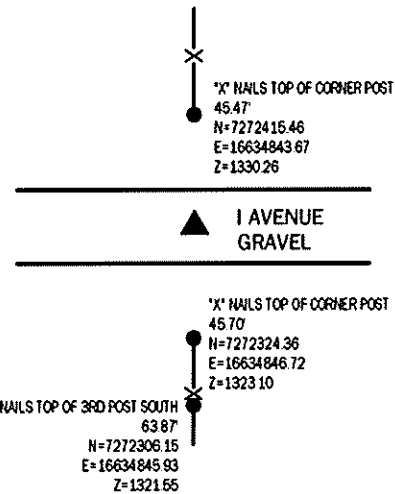
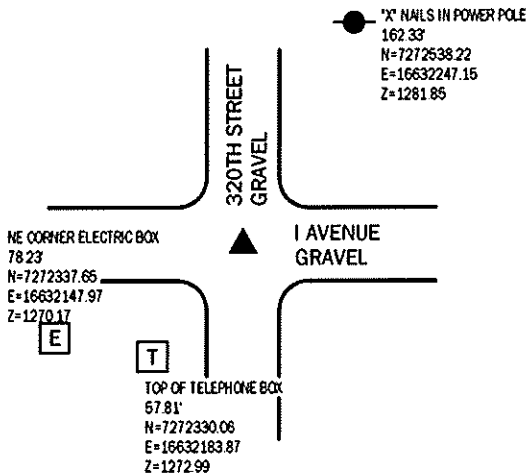

*All distances are measured horizontally unless noted.

I HEREBY CERTIFY THAT THIS LAND SURVEYING DOCUMENT WAS PREPARED BY ME OR UNDER MY DIRECT PERSONAL SUPERVISION AND THAT I AM A DULY LICENSED PROFESSIONAL LAND SURVEYOR UNDER THE LAWS OF THE STATE OF IOWA.

Mike Schulte
 MIKE SCHULTE
 2024/07/10
 DATE



LICENSE NUMBER: 17979
 LICENSE RENEWAL DATE IS DECEMBER 31, 2025
 PAGES COVERED BY THIS SEAL: 1 OF 1

LIST CORNERS TO BE INDEXED

CORNER	SECTION	TWP	RANGE
NW CORNER	14	84	38
NE CORNER	15	84	38
SE CORNER	10	84	38
SW CORNER	11	84	38
N1/4 CORNER	14	84	38
S1/4 CORNER	11	84	38

BASIS OF BEARING

IA RCS ZONE 6 - US SURVEY FEET
 1618TH DERIVED - NAD83(2011) EPOCH 2010.00

SCHULTE SURVEYING, INC.

DRAWN BY: SLG
 PROJ NUMBER: 24-043