

Sara Meseck, RECORDER
 Crawford County, Iowa
 Instr. Number: 2024-2069
 Recorded: 11/6/2024 at 8:27:23.0 AM
 Pages 1
 County Recording Fee: \$7.00
 Iowa E-Filing Fee: \$3.13
 Combined Fee: \$10.13
 Revenue Tax:

PREPARED BY AND RETURN TO: MIKE SCHULTE, SCHULTE SURVEYING, INC., 2003 390TH STREET, WESTSIDE, IA 51467 (712) 790-3489

UNITED STATES PUBLIC LAND SURVEY CORNER CERTIFICATE OF
 LAND SURVEY MONUMENTS SITUATED IN SECTION 18, TOWNSHIP 84 NORTH, RANGE 39 WEST, OF THE FIFTH
 PRINCIPAL MERIDIAN, CRAWFORD COUNTY, IOWA. PREVIOUSLY RECORDED IN SEE BELOW IN COUNTY
(book, page Monument number)
 RECORDER'S OFFICE.

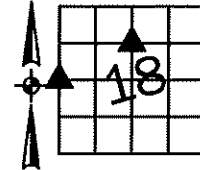

W1/4 CORNER

FND 5/8" REBAR 14" DEEP

N=7269789.76 E=16579686.84 Z=1458.95

USED CERTIFICATE RECORDED IN INSTRUMENT NO. 96-2221 AND A METAL LOCATOR TO FIND TO FIND A 5/8" REBAR 14" DEEP. VERIFIED WITH 4 REMAINING TIES. THIS CERTIFICATE IS BEING FILED TO UPDATE THE REFERENCE TIES.

SE CORNER NE1/4 FRL. NW1/4

FND 1/2" REBAR

N=7271049.27 E=16582430.00 Z=1459.37

NO RECORDED CERTIFICATE FOUND. SEARCHED AREA USING A METAL LOCATOR TO FIND A 1/2" REBAR ON THE NORTH SIDE OF THE CORNER POST. EXAMINED OTHER CORNERS AND FENCES IN THE AREA AND ACCEPTED REBAR. THIS CERTIFICATE IS BEING FILED DUE TO NONE OF RECORD.

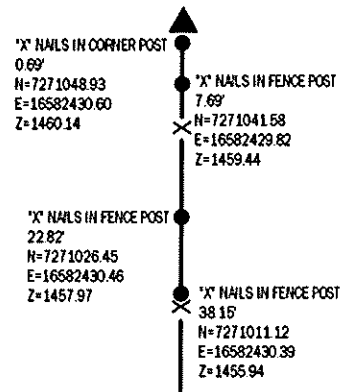
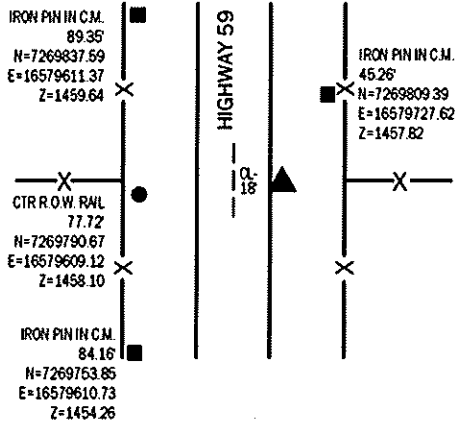

*All distances are measured horizontally unless noted.

I HEREBY CERTIFY THAT THIS LAND SURVEYING DOCUMENT WAS PREPARED BY ME OR UNDER MY DIRECT PERSONAL SUPERVISION AND THAT I AM A DULY LICENSED PROFESSIONAL LAND SURVEYOR UNDER THE LAWS OF THE STATE OF IOWA.

Mike Schulte
 MIKE SCHULTE
 LICENSE NUMBER: 17979
 LICENSE RENEWAL DATE IS DECEMBER 31, 2025
 PAGES COVERED BY THIS SEAL: 1 OF 1
 2024/11/06
 DATE

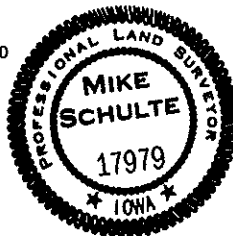

LIST CORNERS TO BE INDEXED

CORNER	SECTION	TWP	RANGE
SE CORNER NE1/4 FRL. NW1/4	18	84	39
W1/4 CORNER	18	84	39
E1/4 CORNER	13	84	40

BASIS OF BEARING
 IaRCS ZONE 6 - US SURVEY FEET
 IaRTH DERIVED - NAD83(2011)(EPOCH 2010.00)

SCHULTE SURVEYING, INC.

DRAWN BY: SLG
 PROJ NUMBER: 24-082