

Sara Meseck, RECORDER
 Crawford County, Iowa
 Instr. Number: 2024-2049
 Recorded: 11/4/2024 at 9:02:39.0 AM
 Pages 1
 County Recording Fee: \$7.00
 Iowa E-Filing Fee: \$3.13
 Combined Fee: \$10.13
 Revenue Tax:

PREPARED BY AND RETURN TO: MIKE SCHULTE, SCHULTE SURVEYING, INC., 2003 390TH STREET, WESTSIDE, IA 51467 (712) 790-3489

UNITED STATES PUBLIC LAND SURVEY CORNER CERTIFICATE OF
 LAND SURVEY MONUMENTS SITUATED IN SECTION 04, TOWNSHIP 83 NORTH, RANGE 38 WEST, OF THE FIFTH
 PRINCIPAL MERIDIAN, CRAWFORD COUNTY, IOWA. PREVIOUSLY RECORDED IN SEE BELOW IN COUNTY
(book, page instrument number)
 RECORDER'S OFFICE.

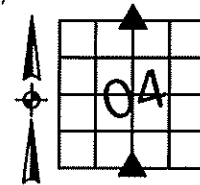

A SURVEY IN THE AREA WAS MADE THAT REQUIRED THESE SECTION CORNERS. BUT THE PLAT HAS NOT BEEN RECORDED YET.

N1/4 CORNER

SET 5/8" REBAR YPC #17979

N=7251374.85 E=16624413.53 Z=1265.55

USED CERTIFICATE RECORDED IN INSTRUMENT #91-1377 TO SEARCH AREA. FOUND NOTHING. SET 5/8" REBAR YPC #17979 BASED ON REFERENCE TIES.

THIS CERTIFICATE IS BEING FILED TO UPDATE THE MONUMENT.

S1/4 CORNER

FND CONCRETE MONUMENT

N=7246667.03 E=16624274.36 Z=1262.09

USED CERTIFICATE RECORDED IN INSTRUMENT #91-1377 TO FIND A CONCRETE MONUMENT. VERIFIED WITH 3 REMAINING TIES.

THIS CERTIFICATE IS BEING FILED TO UPDATE THE REFERENCE TIES.

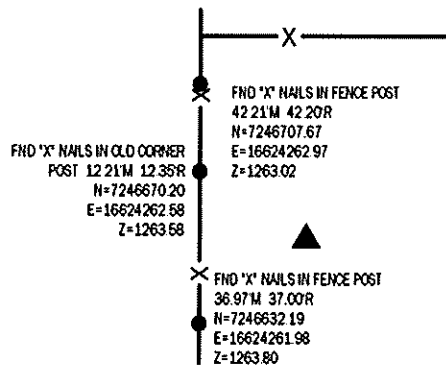
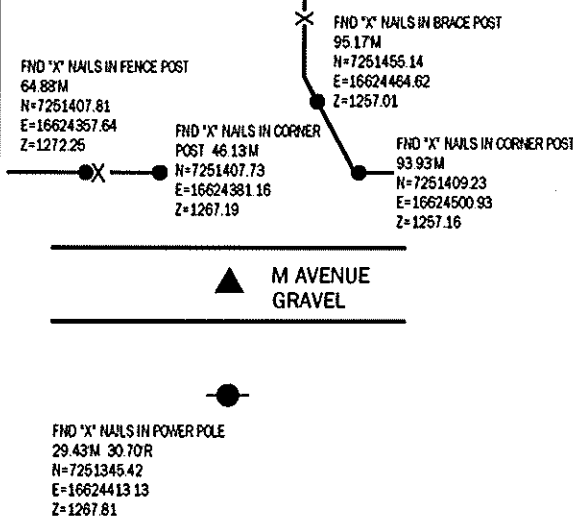

*All distances are measured horizontally unless noted.

I HEREBY CERTIFY THAT THIS LAND SURVEYING DOCUMENT WAS PREPARED BY ME OR UNDER MY DIRECT PERSONAL SUPERVISION AND THAT I AM A DULY LICENSED PROFESSIONAL LAND SURVEYOR UNDER THE LAWS OF THE STATE OF IOWA.

Mike Schulte
 MIKE SCHULTE
 LICENSE NUMBER 17979
 LICENSE RENEWAL DATE IS DECEMBER 31, 2025
 PAGES COVERED BY THIS SEAL: 1 OF 1



LIST CORNERS TO BE INDEXED

CORNER	SECTION	TWP	RANGE
N1/4 CORNER	4	83	38
S1/4 CORNER	33	84	38
S1/4 CORNER	4	83	38
N1/4 CORNER	9	83	38

BASIS OF BEARING

to RCS ZONE 6 - US SURVEY FEET
 to RTH DERIVED - NAD83(2011)(EPOCH 2010.00)

SCHULTE SURVEYING, INC.

DRAWN BY: MLS/SLG
 PROJ NUMBER: 23-028