

INDEX Yes  
 SCAN \_\_\_\_\_  
 FOLLOW UP \_\_\_\_\_  
 PROOF \_\_\_\_\_

Instrument #: 2024-0441  
 03/20/2024 08:47:40 AM Total Pages: 1  
 PLC PLAT COR CERT  
 Recording Fee: \$0.00 Transfer Tax: \$0  
 Sara Meseck, Recorder, Crawford County Iowa



PREPARED BY: PAUL ASSMAN-CRAWFORD COUNTY ENGINEER'S OFFICE-COURTHOUSE-DENISON, IA.-712-263-2449

UNITED STATES PUBLIC LAND SURVEY CORNER CERTIFICATE  
 OF

LAND SURVEY MONUMENT SITUATED IN EAST BOYER TOWNSHIP, WEST 1/4 CORNER OF SECTION 20, T-83N,  
 R-38W OF THE FIFTH P.M. CRAWFORD COUNTY, IOWA.

PREVIOUSLY RECORDED AS NO. 97-1884

MONUMENT DESCRIPTION AND REMARKS

WEST 1/4 CORNER SEC. 20-83-38

FOUND 5/8" IRON PIN WITH CAP # 8893 0.3' DEEP.  
 COUNTY GRADED ROAD AND IRON PIN WAS NOT  
 DISTURBED 1.2' DEEP. CORNER WAS RETIED.

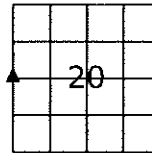

WEST 1/4 CORNER SEC. 20-83-38

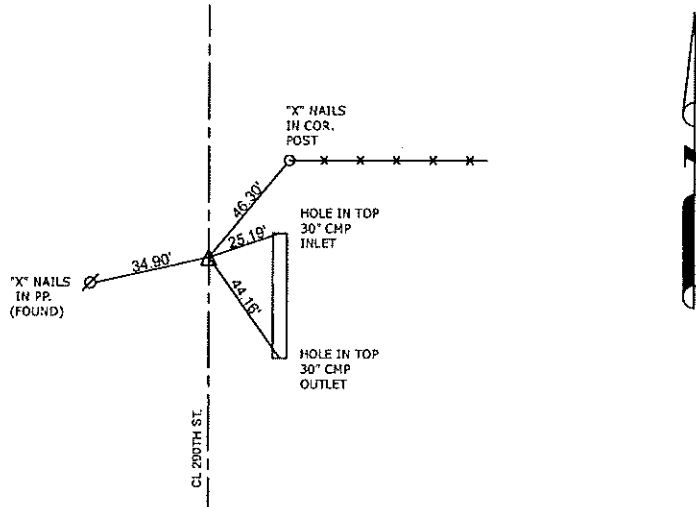

ALL TIE DISTANCES ARE MEASURED HORIZONTALLY USING GPS

CERTIFICATION:

I HEREBY CERTIFY THAT THIS LAND SURVEYING DOCUMENT WAS PREPARED AND THE RELATED SURVEY WORK WAS PERFORMED BY ME OR UNDER MY DIRECT PERSONAL SUPERVISION AND THAT I AM A DULY LICENSED LAND SURVEYOR UNDER THE LAWS OF THE STATE OF IOWA.

*Paul J. Assman*  
 Signature

2/20/24  
 Date of Survey

PAUL J. ASSMAN  
 Typed Name

11982  
 L.S. No.

12-31-24  
 License Renewal Date

Pages covered by this seal 1

